



Electrolux

Modular Cooking Range Line 900XP Full Module Electric Grill

ITEM #

MODEL #

NAME #

SIS #

AIA #



Electrolux



Modular Cooking Range Line 900XP Full Module Electric Grill

391076 (E9GREHGCFO)

900XP FULL MODULE
ELECTRIC GRILL - 400 V

Short Form Specification

Item No.

Heating via incoloy armoured heating elements positioned under the cooking grid. Cooking surface grids in cast iron, easily removable for cleaning. Cast iron grids can be rotated for the grilling of fish or meats. Includes drip tray for the collection of grease and fat. Exterior panels of unit in stainless steel with Scotch Brite finish. Extra strength work top in heavy duty 2 mm stainless steel. Right-angled side edges to allow flush-fitting junction between units.

Main Features

- Incoloy armoured heating elements positioned under the cooking grid.
- Each bank of elements has a temperature controlled thermostat.
- Regulators with fixed high and low positions for precise control.
- Power indicator light.
- Heavy duty cast iron cooking grid lifts off for ease of cleaning.
- Cast iron grids can be rotated for grilling of fish or meats.
- Drip tray to collect residual cooking grease and fat.
- Stainless steel high splash guards on the rear and sides of cooking surface. Splash guards can be easily removed for cleaning and are dishwasher-safe.
- The special design of the control knob system guarantees against water infiltration.
- IPX5 water protection.

Construction

- Unit is 93 cm deep to give a larger working surface area.
- Exterior panels in Stainless Steel with Scotch Brite finish.
- 2 mm work top in Stainless steel.
- Model has right-angled side edges to allow flush fitting joints between units, eliminating gaps and possible dirt traps.

Optional Accessories

- Junction sealing kit PNC 206086 ☐
- Flanged feet kit PNC 206136 ☐
- Pair of side kicking strips for concrete installation PNC 206157 ☐
- Kit 4 feet free standing grill for installation on concrete socle PNC 206163 ☐
- Pair of side kicking strips (not for refr-freezer base) PNC 206180 ☐
- 2 panels for service duct for single installation PNC 206181 ☐
- 2 panels for service duct for back to back installation PNC 206202 ☐
- 2 side panels for free standing grill PNC 206207 ☐
- Stainless steel grid for free standing grills PNC 206285 ☐
- Stainless steel grid with drainage channels for free standing grills PNC 206286 ☐
- Scraper for free standing grills PNC 206299 ☐

APPROVAL:



Electrolux

Modular Cooking Range Line 900XP Full Module Electric Grill

Front

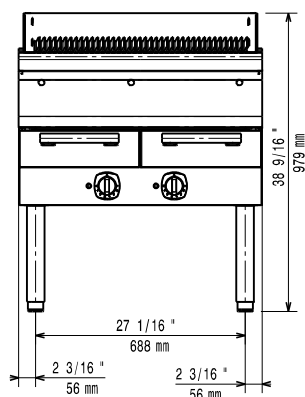

Top

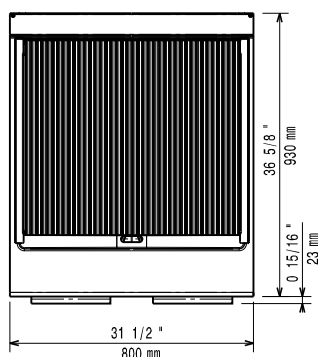

El = Electrical connection

Side

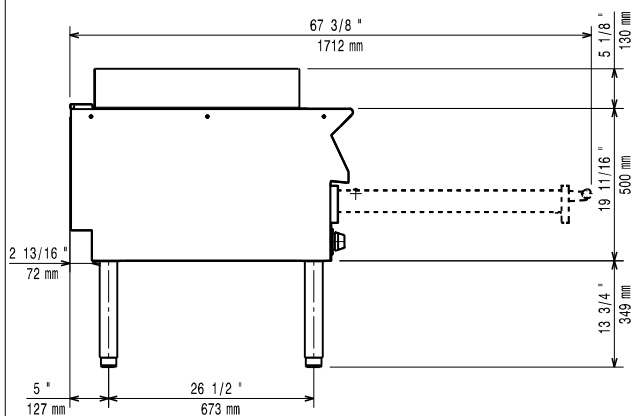

Electric

Supply voltage:

391076(E9GREHGCF0)

400 V/3/3N ph/50/60 Hz

Connected load:

15 kW

Total Watts:

15 kW

Key Information:

External dimensions, Height: 850 mm

External dimensions, Width: 800 mm

External dimensions, Depth: 930 mm

Net weight: 94 kg

Shipping weight: 115 kg

Shipping height: 850 mm

Shipping width: 800 mm

Shipping depth: 930 mm

Shipping volume: 0.61 m³

If appliance is set up or next to or against temperature sensitive furniture or similar, a safety gap of approximately 150 mm should be maintained or some form of heat insulation fitted.



Modular Cooking Range Line
900XP Full Module Electric Grill

The company reserves the right to make modifications to the products without prior notice. All information correct at time of printing.

2011.02.21